

Leslie School of Dance - Summer Dance Camp (LSOD-SDC) 2026 Information Packet

Our Mission

To create an out of studio camp where girls & boys, ages 4 years and older with little or a lot of dance experience come together for multiple days to have fun in with dance, create lasting friendship, and work as a team to present a final show to family and friends.

Facility & Usage

LSOD-SDC annual out of studio dance camp takes place in the summer at The Y at Watson Woods located in Painted Post, NY. Accommodations, classes, activities & meals run either at the Upper Retreat Village (3 cabins & 1 recreation hall), the Main Lodge & Extension Facility (i.e., classrooms, meals & showcase) and designated outside areas (climbing wall, archery, jumping pillow, Lego Rink, axe throwing, etc.) over a 4-day period.

Staff, counselors, and campers are assigned a room for their belongs in one of the 3 cabins for the duration of the camp: Cabin 1 is the first one on the right; Cabin 2 is the second one on the left; and Cabin 3 is the third one straight ahead and to the left.

There is a “Medical / Quiet Room” in one of the 3 cabins (to be determined after registration closes). It will be open from 9:00 am – 9:00 pm. If a camper does not feel well, they are to tell a staff member and they will be to escort to the medical room so they can relax and determine what course of action is needed.

Wifi is available at Watson’s Main Lodge and sporadically available at the retreat cabin site.

Refer to Addendums 1-4 for directions, maps & diagrams of the facility.

Code of Conduct

Participation in LSOD-SDC is subject to the observance of the program rules. Any participant who knowingly violates this code of conduct is subject to discipline, up to and including removal from the activity he or she is participating in or the entire camp (at his/her own expense).

Determination of disciplinary action shall be done with input from the staff overseeing the program or activity. Parents will be notified to meet & discuss any issues. The final decision about discipline action will be made by the Camp Manager.

Camper Programs / Size / Arrival & Departure Schedule

Campers sign up to attend one of three programs: Full time, day (regular or extended) or wee. Refer to the website for program details (www.lsodsummerdancecamps.com).

2026 Registration closes on or before June 15, 2026.

To ensure a proper balance of campers to staff each program has a cap of participants. If this happens, we will close that program's registration and details will be posted on the website and our Facebook & Instagram pages. Individuals will be able to email us if they wish to be placed on a waiting list if the program reopens.

Each camp programs have specific arrival & pick up times. This information is a guideline for camp families and it subject to change. Parents, please arrive 15 minutes prior to pick up time.

Refer to Addendum 5: Arrival & Departure

Cabin Rooms/Roommates/Packing List

Each cabin has 8 rooms. Rooms have a window, 4 bunk beds, a chair, towel rack & dresser or desk (variety of sizes). There is 1 double electrical outlet in each room. Refer to the website for pictures.

All campers (full time, day & wee) are assigned a cabin room for the duration of the camp.

- Full time campers can have up to 4 in a room. Campers can submit potential roommates, and we do our best to fill your request.
- Day & Wee campers may have more in their room since they are not staying overnight.
- Day Extenders are either together or mixed in with full time campers. Campers can submit potential roommates, and we do our best to fill your request.
- An email is sent a few weeks after registration closes with camper's cabin and roommate assignments.

Each cabin has 2 full time staff chaperones. The Wee campers have their own staff chaperone. Prior to coming families will receive a staff cabin assignment list.

Campers are not permitted to switch rooms without approval from the camp manager only.

Refer to Addendum 6: LSOD – SDC Suggested Packing List

Meals, Snacks, Beverages & Donations

Meals will take place either on the camp site or in the main lodge dining hall.

We ask that there is no food or beverages stored in rooms without prior approval. The camp sets up a snack and beverages station in each cabin gathering area and is open to everyone.

There is a refrigerator and microwave in all four locations and is community property.

We ask that each camper bring their own personal water bottle. We will have water stations in the 3 cabins and the recreational hall available to everyone all times. Camper can also fill up their water bottles in the bathrooms. Please note the faucets are low, so large water bottles many not fit.

Donations are welcomed (and completely optional). After registration official closes, an email is sent out to camp families with a link from Sign Up Genius.

Annual “Themed” Cabin Room Door Contest

All campers (full, day and wee... and yes counselors) are welcome to participate but not obligated. Visit LSoD SDC Facebook & Instagram and the website gallery to see past door photos. There are 5 official categories:

- *The Best Overall Camp Theme Door*
- *The “Out of the Box”, Unique, Creative Camp Theme Door*
- *The WOW, You Surprise Me Door*
- *The Mixing of Camp Life with the Theme Door*
- *Judge’s Choice Door*

Rules & Regulations

- *You must work with your roommates.*
- *Your door is a blank canvas. Your special designed camp door name tags will be located on the wall next to your door. You can leave them there or incorporate them into your decorations.*
- *All items must be on the door.*
- *The door must be able to open & shut without any issues.*
- *Lights are not permitted.*
- *Do not put anything on the frame and or outside surround wall.*
- *Heavier decorations have a bigger chance of falling off.*
- *Homemade/creative items bring you more points than store bought.*
- *Doors must be completely decorated by Thursday night.*
- *Pictures of all doors will take place on Friday morning.*
- *Winners will be announced at Friday night’s dinner.*
- *All campers in the winning rooms will receive a prize. Prizes vary from year to year.*

Costumes / Camp Performance / Camp Awards

Each year there is a special camp theme and on the last day campers do a performance for their family and friends. A cast list with costume information is sent out by email after registration closes.

The show will be held at the Watson Lodge / Dining Room. The performance is free and open to everyone. Parents will be asked at check in, how many people will be attending so we can set up enough seating. Light refreshments will be served. After the show there is a camp group photo and awards.

Schedule

- *1:30 pm – Doors Open*
- *2:00 pm – Performance*
- *3:00 pm – Photos & Camp Paper Plate Awards*
- *4:00 pm – Pack up, more photos, hugs before heading home.*

The performance is filmed and lots of pictures are taken at dress rehearsal and during the show. They are added to our website, put on “The Band” app, Facebook and Instagram. You are welcomed to take pictures or videos of your own. If you do, please do not disturb other audience members or the cast.

Consent Form

The LSoD-SDC consent form must be filled out and signed by all campers and counselors either prior to camp or at camp check in.

Refer to Addendum 7: Consent Form

ADDENDUM 1: DIRECTIONS TO THE Y AT WATSON WOODS

9620 Dry Run Road, Painted Post, NY 14870

By Air: The Elmira-Corning Regional (ELM) is located at exit 50, Route 17/Interstate 86. It is served by US Airways, United Airlines, Delta Airlines, and Continental. Rental cars are available at the airport. Homestead staff may be available to make airport pick-ups and drop-offs for participants in Watson Homestead sponsored programs. Please inquire.

By Bus and Rail: NY Trailways and Shortline Bus services drop off passengers in Corning, NY. There is no passenger rail service to our area. The closest Amtrak terminals are Rochester and Syracuse.

From Albany, Massachusetts & New England: Find your way to Interstate 88 (just northwest of Albany, off I-90). Travel west on I-88 to Binghamton. then go west on Interstate 86 (a.k.a. NY State Route 17) to exit 42. At top of exit ramp, turn right onto Steuben Co. Route 26, Meads Creek Road. You will travel just over 3 miles to the Homestead entrance sign. Turn right on Dry Run Road and follow signs to the Main Lodge.

From Canada, Buffalo & Rochester: Take Interstate 90 East to Rochester, then 390 South. Route 390 T's into Interstate 86 (a.k.a. NY State Route 17). Take I-86 east to exit 42. At top of exit ramp, turn left onto Steuben Co. Route 26, Meads Creek Road. You will travel just over 3 miles to the Homestead entrance sign. Turn right on Dry Run Road and follow signs to the Main Lodge.

From Jamestown and the West: Travel east on Interstate 86 (a.k.a. NY State Route 17) to exit 42. At top of exit ramp, turn left onto Steuben Co. Route 26, Meads Creek Road. You will travel just over 3 miles to the Homestead entrance sign. Turn right on Dry Run Road and follow signs to the Main Lodge.

From Pennsylvania and the South: Travel north on State Route 15 N (future interstate 99) from Harrisburg to Interstate 86 West (a.k.a. NY State Route 17) at Painted Post. Take Interstate 86 West to exit 42. At top of exit ramp, turn right onto Steuben Co. Route 26, Meads Creek Road. You will travel just over 3 miles to the Homestead entrance sign. Turn right on Dry Run Road and follow signs to the Main Lodge.

From the New York metropolitan area: Travel west on Interstate 86 (a.k.a. NY State Route 17) to exit 42. At top of exit ramp, turn right into Steuben Co. Route 26, Meads Creek Road. You will travel just over 3 miles to the Homestead entrance sign. Turn right on Dry Run Road and follow signs to the Main Lodge.

ADDENDUM 2: MAP TO THE Y AT WATSON WOODS



ADDENDUM 3: DIAGRAM/LAYOUT OF THE MAIN LODGE

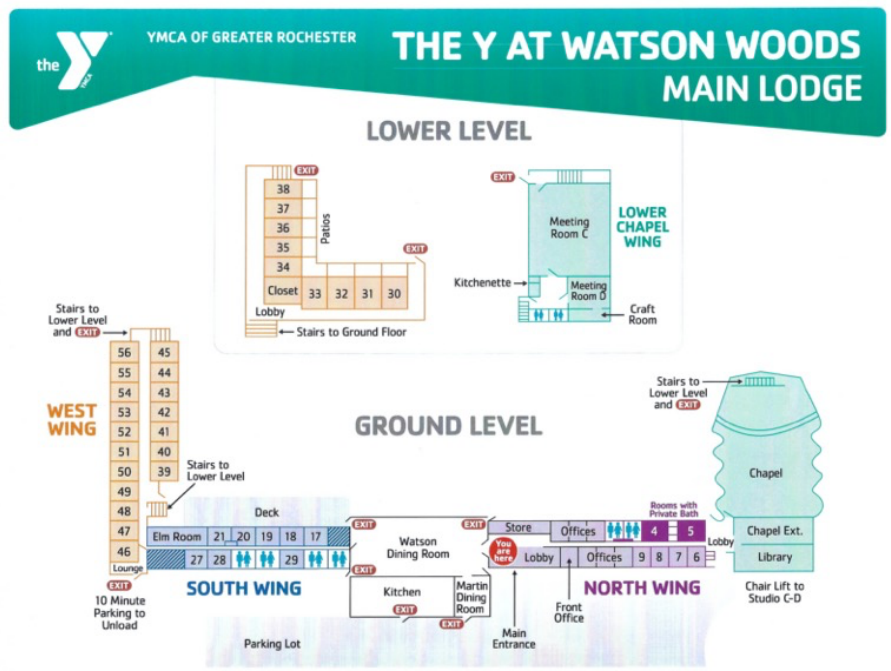

ADDENDUM 4: DIAGRAM/LAYOUT OF RETREAT VILLAGE CABIN

The Y at Watson Woods - Cabin Floor Plan

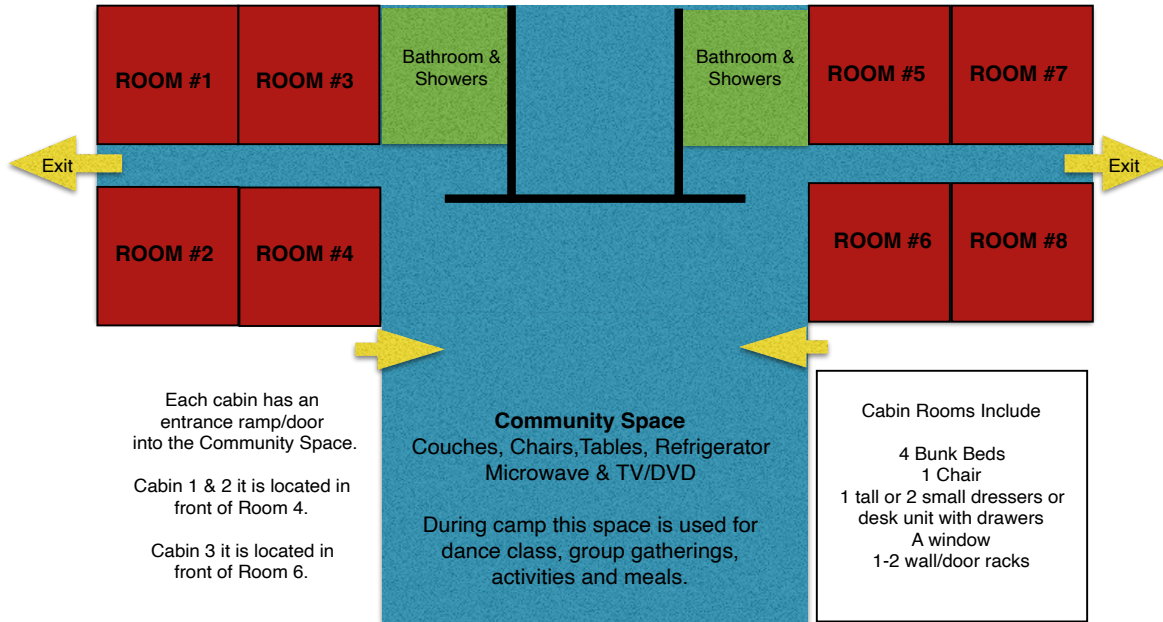

ADDENDUM 5: ARRIVAL & DEPARTURE

Following information is a guideline and is subject to change.

Camp Day 1

- *Parent/Guardians along with their camper are to check in at the Recreation Hall on Wednesday between 10:00 am – 11:30 am. You can utilize this time to set up your room.*
- *All campers are to meet at the recreation hall by 11:30 am to kick off camp!*
- *Wee campers are picked up at 4:00 pm.*
- *Day campers (regular) are picked up at 6:00 pm.*
- *Day campers (extenders) are picked up at 9:30 pm.*

Camp Days 2 & 3

- *Wee & Day campers arrive between 8:30 am – 9:00 am Thursday & Friday.*
- *Wee campers are picked up at 4:00 pm on Thursday & Friday.*
- *Day campers (regular) are picked up at 6:00 pm on Thursday & Friday.*
- *Day campers (extenders) are picked up at 9:30 pm on Thursday.*
- *Day campers (extenders) stay over Friday night.*

Camp Day 4

- *Wee & Day campers are to arrive @ 8:30 am on Saturday.*
- *Full time & Day Camp (extender) campers will pack up their belongings that morning & have place all items on their bunk ready for parent pick up.*
- *All campers & staff will move over to the main lodge by 9:30 am for dress rehearsal, lunch, and performance.*
- *Parents can pack up their campers' belongings starting @ 11:30 am.*
- *The performance will be held at the Watson Lodge / Dinning Hall. Parents can relax up at the cabin area until the performance doors open.*
- *Doors will open @ 1:30 pm.*
- *Performance, Cast Photos & Camp Awards 2:00 pm – 4:00 pm. Light refreshments will be served.*
- *Campers can leave after awards.*
- *Staff, Instructors & Counselors will assist in clean-up/pack-up after the performance.*

ADDENDUM 6

LSoD -SDC Suggested Packing List

(*Indicates items for Day & Wee Campers)

Dance class*

- Leotards
- Sport or Dance Bra & Shorts
- Dance Tights (optional)
- Older Dance shoes: Ballet, Tap, Jazz, Hip Hop, Lyrical, socks and/or Apolla Shocks.
Please do not bring new items, they will get dirty.

Bedroom

- Fitted/Flat Set of Sheets, blanket and/or sleeping bag.
- Pillow(s) & pillowcase(s)
- Fan (coordinate with roommates).
- Bedtime Buddy/Stuff Animals
- Laundry basket (for dirty clothes)
- Night Light (Do not buy one, we have extras. Ask for one at check in).

Shower

- Bath & Hand Towels
- Outside / Water Game Beach Towel*
- Shampoo/Conditioner
- Soap/Body Wash
- Sponge and/or Wash Cloth
- Toothpaste/toothbrush
- Deodorant/other toiletries
- Brush & Comb*
- Hair ties & Bobbie pins*
- Period Products if needed

Clothes

- Swimsuit / Coverup for outside water games*
- Flip Flops / Outside water shoes*
- Undergarments
- PJs & Robe
- Socks*
- Shorts*
- Shirts*

- Sneakers* (For outside games & a must for wall climbing and archery – no exceptions.)
- Leggings or Sweatpants & long sleeve shirt or sweatshirt to wear at the campfire.

Extra

- A white t-shirt and a pair of shorts (any color) for “Color Wars” (Something you do not care if the colors do not come out). These items will not be used again during camp.
- Flashlight w/new batteries
- Bug Spray if you need a certain type or sensitive to certain brands)
- Medicine (Must be check in) *
- Decorations for your door & room! (Please coordinate with your roommates) *

Performance Necessities

- **VERY IMPORTANT:** A basket or bin for show day to keep your shoes, costume pieces and props in one place. *
- Your show costume & accessories on a coat hanger or in bag with your name on it.

Electronic Devices:

- Are allowed with exception. Please see the “Code of Conduct” regarding WIFI service and usage.

Packing Tips

- Due to the limited space some campers bring their belongings in a plastic drawer bin.
- Get a bathroom carrier to hold all your personal products.
- Label everything possible (especially dance shoes).
- Before you pack everything up, lay it all out on your bed. Check the packing list. Confirm you are not bringing too much. Also, you may find you have 3 shorts and 10 t-shirts.
- Bundle Clothing Packet Idea: Pack a full outfit in a zip lock bag (i.e., underwear, dance shorts and dance top).

ADDENDUM 7
2026 LSoD-SDC CONSENT FORM

To be completed by all attending campers (including counselors). If you are 18 years and older, please complete this form. If you are under 18 years, a parent/guardian must complete this form with you.

I hereby grant permission for my child (print full name) _____
to participate in all educational, dance, sports, and social activities at the 2026 LSoD - SDC held at the Y
@ Watson Woods (Painted Post, NY). All safety precautions will be taken for all activities. If my child is
hurt or injured during the above activities, I understand that Leslie School of Dance or staff is not
responsible.

I, hereby give permission for my child to be photographed & videotaped. I understand...

- Photos & videos will be used to keep a journal of activities and may be used for promotional purposes including flyers, brochures, newspaper, social medial and the website.
- All photos taken are the property of LSoD – SDC Program.

I have read and I understand the LSoD – SDC Code of Conduct and I agree to abide by the rules. I understand I may be removed as a participant from the activity or program, if I fail to follow these rules.

Camper's Signature (all ages)

Date

Print Parent/Guardian's Name

Date

Signature of Parent/Guardian

Date